



7/25 Werona Avenue Killara NSW

1 1 1

Boutique Character Garden apartment - Minute Walk to Rail

Boutique Character Garden apartment - Minute Walk to Rail, only 20 metres to Killara Train station.

Offering on the ground floor which consists of:

- One Bedroom with walk-in robe plus a study
- Lounge/dining
- Modern kitchen with large pantry
- 1 bathroom + extra toilet
- A courtyard to enjoy that afternoon cup of tea.
- Single Lock Up Garage and plenty of on street parking
- Within the Killara High School catchment area.
- Being at the rear of the block from Werona Avenue, east side Killara locale.

View : <https://www.assetrealty.com.au/lease/nsw/north-s-hore-upper/killara/residential/apartment/7803010>



Raymond Chen
0468 997 811



Christine Sheridan
02 9498 7799

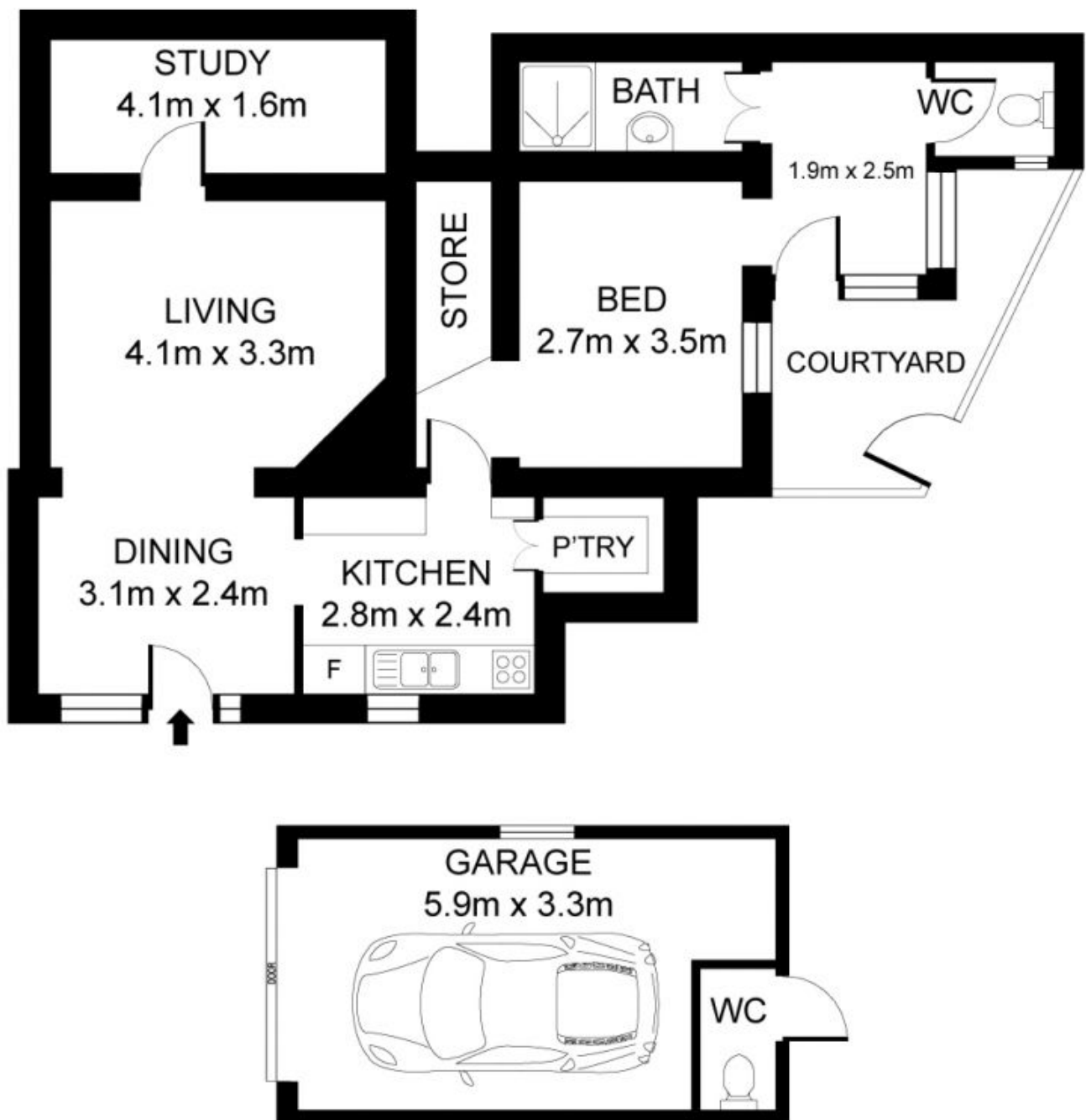

7/25 Werona Avenue, Killara

INTERNAL AREA: 67 SQM APPROX.

ASSET
reality

DISCLAIMER: 3D Property View accepts no liability for the accuracy of details contained within our floor plans. All plans are drawn and also checked to the best of our ability, however information contained in our floor plans such as area calculations are approximate, and have not been surveyed or drawn to scale. Our floor plans are for representational purposes only and should be used as such. Do not attempt to refer to our floor plans for structural or detailed information.