



## 15a Memorial Avenue St Ives NSW

4 3 1

Once in a lifetime opportunity - 1st time offered in 38 years. Positioned in the heart of St Ives and adjacent to St Ives Village Green is this R4 zoned (high density), rectangular shaped parcel of land, offering a flat 955sqm (approx.) with a 21m (approx.) frontage.

This rare development opportunity is presented to the market for the first time in over 38 years and there is scope to construct ten large three-bedroom units, subject to council approval. The house is fully habitable and could also suit those placing a premium on the location and convenience with renovation and building your dream home, an option here. The brick house comprises of three/four bedrooms with a large master bedroom both with built-in robes and walk-in-robes, respectively.

There is an eat-in Kitchen centrally located to the L-shaped lounge/dining, internal laundry with full bathroom and level backyard with entertaining patio. Air-conditioning and polish

**Price** : \$ 4,608,000  
**Land Size** : 955.3 sqm  
**View** : <https://www.assetrealty.com.au/sale/nsw/north-shore-upper/st-ives/residential/house/7700268>



**Ari Akbarian**  
02 9498 7799



**Sima Akbarian**  
02 9498 7799

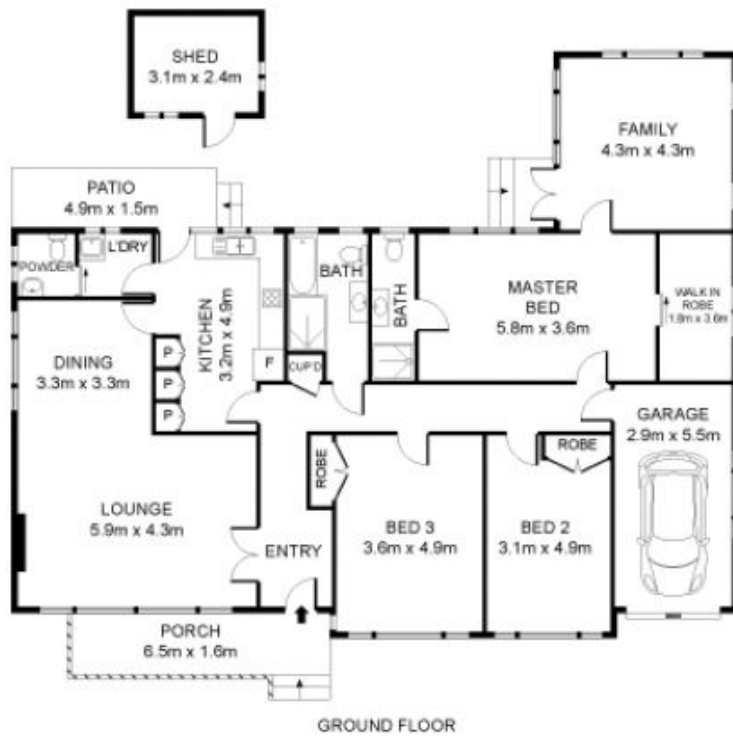

SITE PLAN (NOT TO SCALE)

INTERNAL AREA: 205 SQM APPROX.  
LAND SIZE: 955 SQM APPROX.

15A Memorial Avenue, St Ives



DISCLAIMER: 3D Property View accepts no liability for the accuracy of details contained within our floor plans. All plans are drawn and checked to the best of our ability, however information contained in our floor plans such as area calculations are approximate, and have not been surveyed or drawn to scale. Our floor plans are for representational purposes only and should be used as such. Do not attempt to refer to our floor plans for structural or detailed information.