

## 8 Larnock Avenue Pymble NSW

3 1 2

### Character Family Home in Quiet Convenient Location

Spacious light and bright family home positioned in a quiet east side cul-de-sac location with a sun drenched deck for relaxed entertaining. Short stroll to Gordon East Public School, bus, walk to Gordon and Pymble Station & shops, close to top private schools and in the Killara High School catchment.

- Polished timber floors throughout
- 3 bedrooms with high ceilings, 2 with built-in wardrobes
- Open living and dining room with floor-to-ceiling glass for natural light
- North-East facing entertainer's deck captures a private leafy outlook
- Light filled spacious modern gourmet kitchen with dual sinks & oven

View : <https://www.assetrealty.com.au/lease/nsw/north-hore-upper/pymble/residential/house/7658949>



**Margaret Matthews**  
02 9498 7799

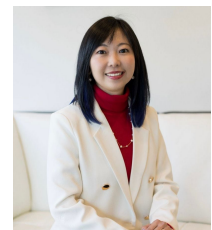

**Renita Yang**  
02 9498 7799

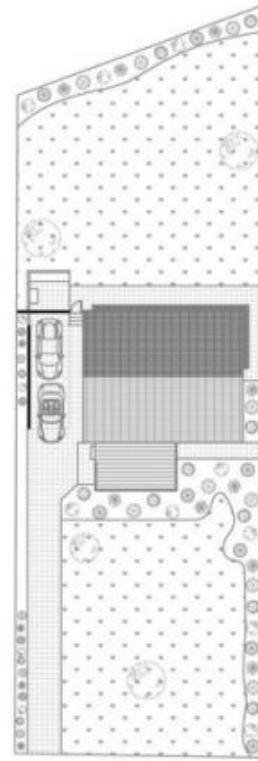

SITE PLAN

All information presented is gathered from third parties and therefore we cannot guarantee it's accuracy. The plans shown here are for presentation purposes & are not part of any legal document or title and are subject to errors, omissions & inaccuracies and should not be used as sole reference. All measurements & figures are approximate. Interested parties should make & rely on their own enquiries.

8 Larnock Avenue, Pymble