

30/1-5 Lynbara Avenue St Ives NSW

2 2 1

Offering peace, prestige and privacy, this two bedroom unit, located on the second floor of the exclusive 'Lynbara Apartments', has been updated for the most discerning buyer. Well appointed, with full brick internal walls the unit excels in style and function with oversized interior proportions adding great separation between the social and bedroom areas. The aspects are one to be desired with district leafy outlooks from every angle. The open plan L-shaped lounge and dining area, is anchored by a gourmet gas kitchen, offering effortless connection to an all-weather alfresco balcony, ideal for dining.

This unit in St Ives receives a perfect 10/10 location score. It's only 200m from shops and cafés, and just 500m from St Ives Shopping Village and City/Gordon Station Buses. Masada College is 500m away, while St Ives Public & High Schools are within a 1km walk. Sydney Grammar School (Boys), Corpus Christi, and Brigidine College (Girls) are

Price : \$ 1,122,000
Land Size : 124 sqm
View : <https://www.assetrealty.com.au/sale/nsw/north-shore-upper/st-ives/residential/apartments/7629988>



Ari Akbarian
02 9498 7799



Margaret Matthews
02 9498 7799

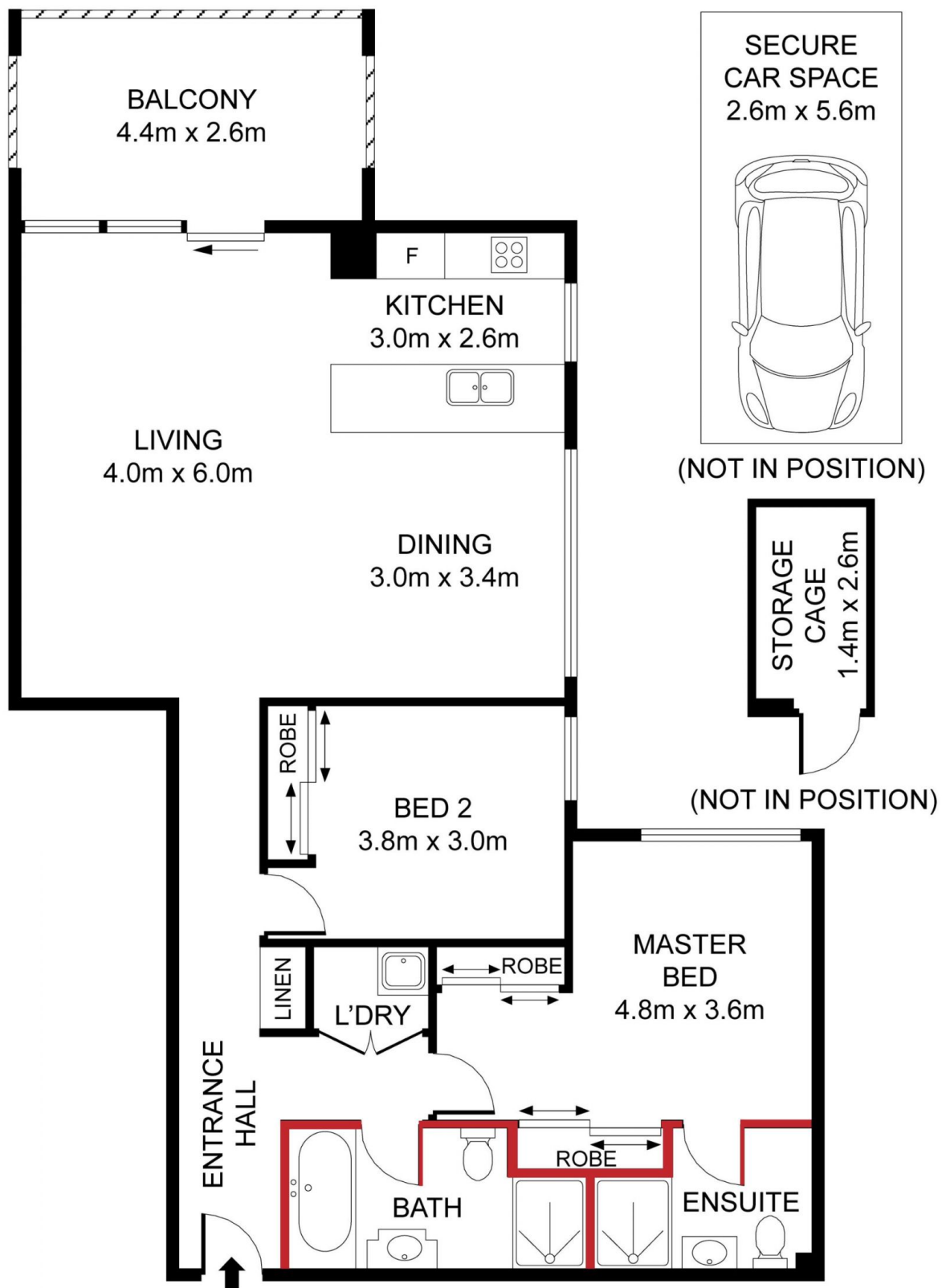

30/1-5 Lynbara Avenue, St Ives

INTERNAL AREA: 95 SQM APPROX.

ASSET
realty

DISCLAIMER: 3D Property View accepts no liability for the accuracy of details contained within our floor plans. All plans are drawn and also checked to the best of our ability, however information contained in our floor plans such as area calculations are approximate, and have not been surveyed or drawn to scale. Our floor plans are for representational purposes only and should be used as such. Do not attempt to refer to our floor plans for structural or detailed information.