

## 18C/803-805 Pacific Highway Gordon NSW

2 1 1

Spacious Two Bedroom apartment set in the heart of Gordon - Walk to Gordon Shopping Centre and Train station

This double brick 2 bedroom apartment, situated on the Top floor features:

- Spacious lounge/dining area flowing to the entertaining balcony
- Two bedrooms with built-in robes.
- Modern gas kitchen with stainless steel appliances
- Large bathroom with separate bath and heater lights
- Internal laundry with clothes dryer, 2 x split system Air/Conditioning
- Indoor heated lap pool, Intercom, Lift access
- Internal access to garage area, single lock-up garage with visitor parking
- Short walk to Gordon Train Station, parks, local schools and Gordon Shopping Arcade.

**View :** <https://www.assetrealty.com.au/lease/nsw/north-s-hore-upper/gordon/residential/apartment/5727182>



**Sima Akbarian**  
02 9498 7799

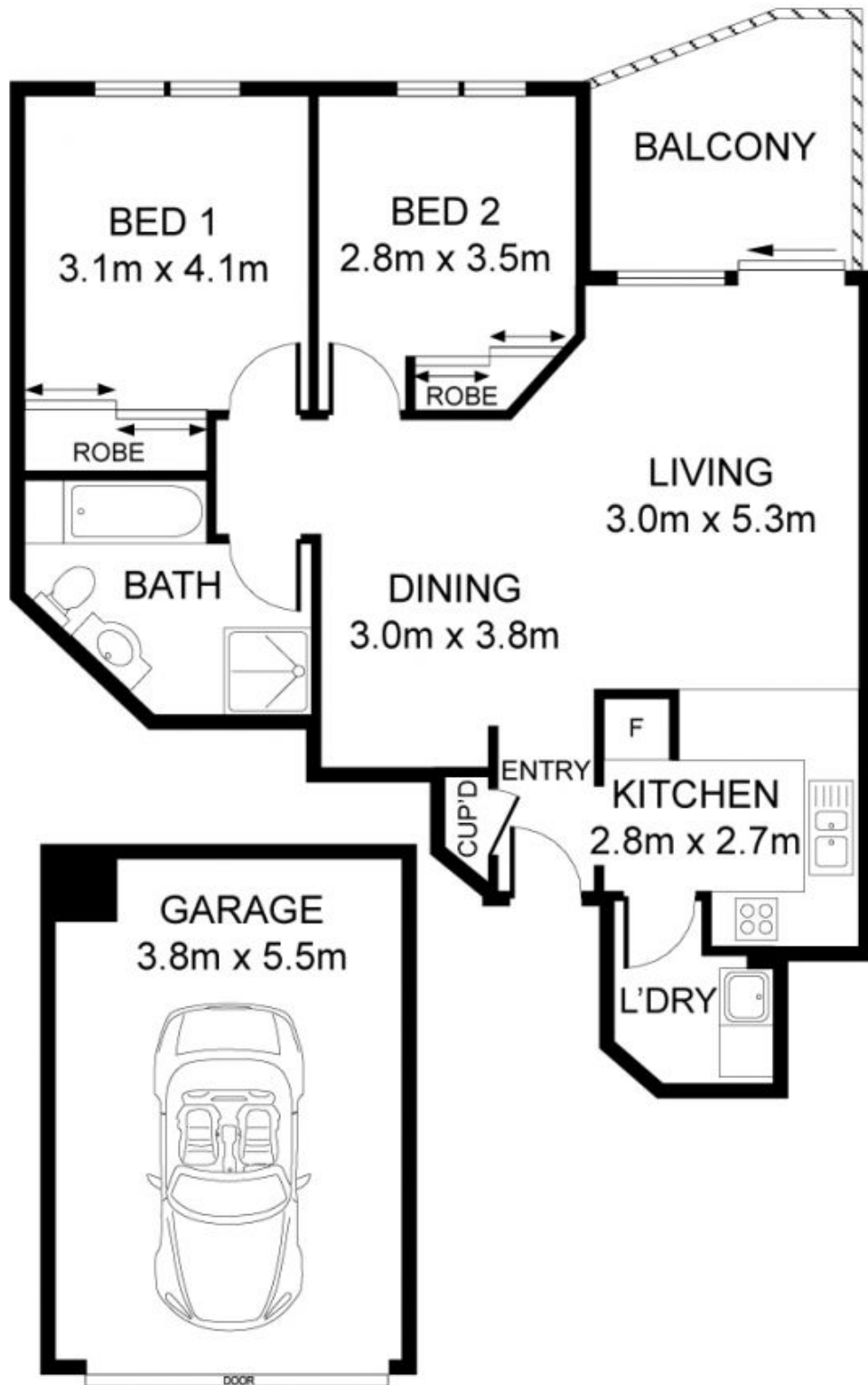

**18C/803-805 Pacific Highway, Gordon**

GARAGE: 21 SQM APPROX.  
TOTAL AREA: 95 SQM APPROX.

DISCLAIMER: 3D Property View accepts no liability for the accuracy of details contained within our floor plans. All plans are drawn and also checked to the best of our ability, however information contained in our floor plans such as area calculations are approximate, and have not been surveyed or drawn to scale. Our floor plans are for representational purposes only and should be used as such. Do not attempt to refer to our floor plans for structural or detailed information.